



MX SERIES Essential Model MX2e

Instructions + Quick Setup Guide



Quick Setup, Tutorials, and Troubleshooting

Scan QR code with your phones camera or visit
vaulteksafe.com/support and select your model.

QUICK SETUP GUIDE

Follow these steps to get your safe up and running.

Step 1: Install Four AAA Batteries. (Not Included)

Your safe requires four AAA batteries and can be left plugged in continuously. The batteries provide power for about 1 year.

Important! The safe will beep periodically until the backup batteries are installed to alert you that no batteries are installed.

Step 2: Program the Master Code.

First time users should change the default code as soon as possible to prevent unauthorized access to your safe, so it should be kept confidential.

Step 3: Register the safe.

Registration provides many benefits including three year warranty, technical support, and ordering replacement keys should you misplace them.

If you have any questions about your safe or need help configuring the system, we encourage you to visit vaulteksafe.com/support/ and select your model.

AT A GLANCE

The Vaultek® Essential MX is a tough and rugged, quick access safe. Its solid structure and penetration resistant design makes it ideal for storing valuables such as firearms, jewelry, cash, and other personal items. Powered by four AAA batteries, the safe combines high security with complete access control.

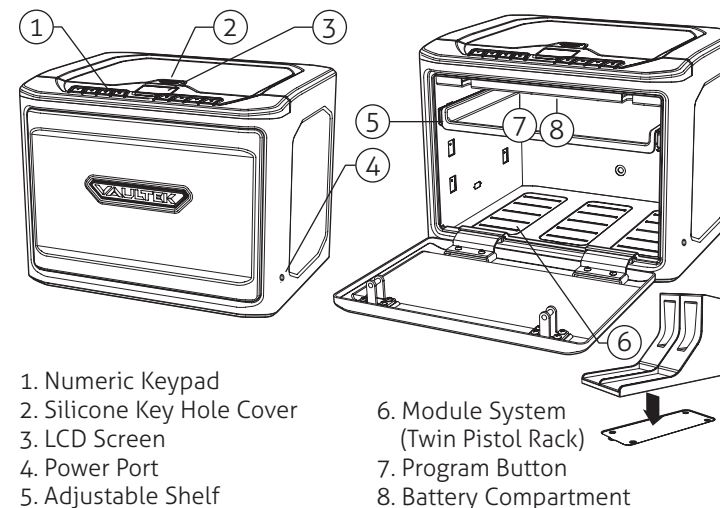

Battery Power: This safe has battery power via four AAA batteries (not included) and needs them for normal function.

Optional Plug-In Power: This safe can be plugged into a power source using the included power cable. Great in the event you lose the keys and the battery dies. Simply plug-in the safe to a power source to have continuous power.

Open Door Alarm: Your safe features an open door alarm that will sound when the safe door is left open for more than 8 minutes. By default, this alarm is ON. To toggle this feature press and hold the '5' key and Program button together for 3 seconds. The LCD screen will indicate ON or OFF.

Keypad: The numeric keypad responds quickly for rapid access and has a built-in proximity sensor that lights up when your hand brushes against the safe.

Key: Two keys are provided for manual access to the safe.

Security Sleep Mode: Activates when six (6) consecutive incorrect keypad entries are entered. The safe will not accept any entries for four minutes. If any additional attempts are made the alarm will beep. The security sleep mode can be cleared upon unlock of the safe by the backup keys.

More features on the backside.

LCD Screen

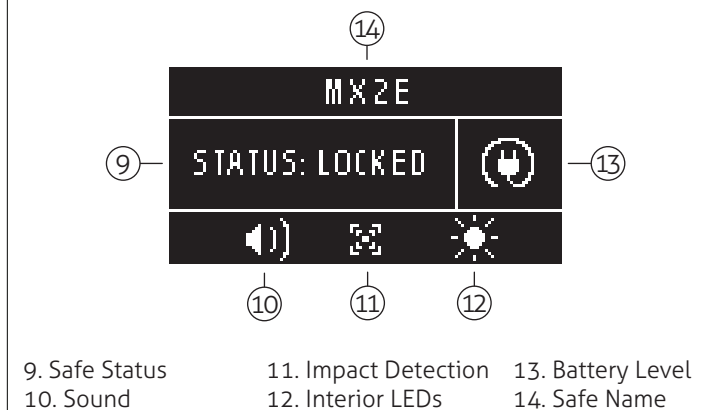

Manual Key Cover

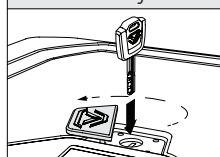

Program Button

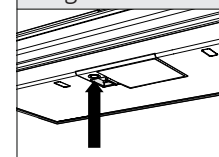

Power Port

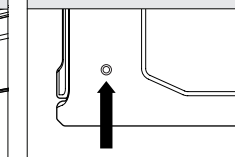

BATTERY POWER

This safes is powered by four AAA batteries that need to be installed. The batteries will run and last about 1 year. The included backup keys can be used at any time.

Battery Power

1. Open the safe. Key entry is located at the top of the safe.

2. Remove the battery compartment by pressing down on the tab near the top of the battery cover. Install four AAA batteries (A). For optimal performance, we recommend Duracell/Energizer or other reputable brands.

Optional Plug-In Power

The event you lose the keys and the battery dies, plug-in the safe to a power source.

1. Plug-in the safe to a power source using the included cable (B). This provides continuous power.

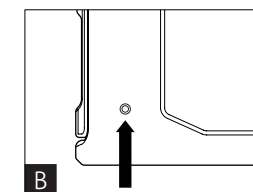
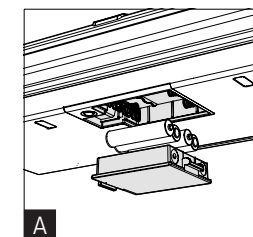

MASTER CODE TIPS

- Your code can be as short as 4 digits, or up to 8 digits in length. We recommend a code 6 to 8 digits in length using at least one of each key to make it more difficult for someone to guess.
- Avoid easy-to-guess digits such as 1234, 1111, 2222, etc.
- Two keys cannot be pressed simultaneously.
- The default master code is 1-2-3-4.
- Programming a new master code will overwrite your previous code.

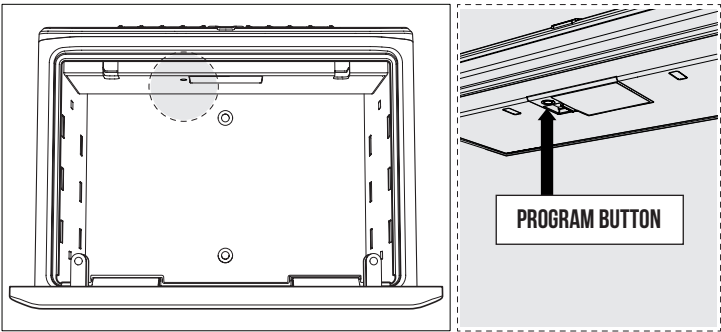

MASTER CODE PROGRAMMING

First time users should change the default code as soon as possible to prevent unauthorized access.

1. Open the safe. With the safe open, press and hold the '1' key then the Program button together for 3 seconds until the LCD screen prompts you to enter your new code.
2. Enter your NEW master code.
3. Press and hold the '1' key then the Program button together a second time for 3 seconds until the LCD screen prompts you to re-enter your new code.
4. Enter your NEW master code a second time.
5. Press and hold the '1' key then the Program button together a third time for 3 seconds until the LCD screen confirms the code change is complete.

Troubleshooting! If you make a mistake and the new code will not work, simply start over with step 1.

MODULAR INTERIOR

Your safe features a customizable interior system with a height adjustable pull out shelf and drop in modules to help with storage and organization.

Adjust the Interior Shelf Height

1. Lift the shelf vertically to remove from mounting brackets.
2. Remove the screw/mounting brackets from the sidewalls and reinstall at the desired height.
3. Place shelf back onto the mounting brackets and press down firmly to install.

Drop In Modules

A twin pistol rack is included and can be placed wherever there is an insert cover. A range of different modules are available for purchase.

1. Remove the interior covers to access the slots to attach each module, and snap into place.

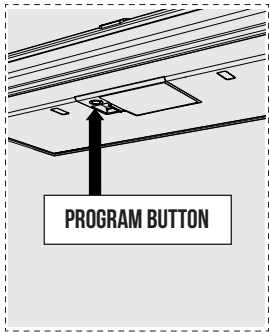

SECURING THE SAFE

Your Vaultek safe can be secured via the included mounting screws to a flat surface using the pre-drilled holes on the bottom and back of the safe.

Floor Mounting: Remove the interior cover to access bottom mounting holes.

Wall Mounting: Locate the holes on the back of the safe.

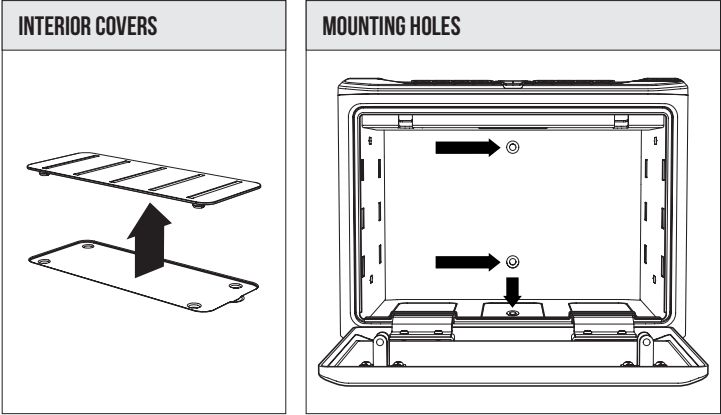

KEYPAD HOTKEYS

Battery Status: To check the battery level press and hold keys '6' and '8' together for 3 seconds. The LCD screen will indicate the battery level.

Tamper Detection: To check for tampering press and hold keys '2' and '4' together for 3 seconds. The screen will indicate TAMPER OCCURRED or CLEAR. You can reset the tamper detection by opening the safe through one of the authorized entry points.

Sound (Medium by Default): Your safe has four different sound pitches, Low, Medium, High, and OFF. To toggle the sound press and hold keys '1' and '3' together for 3 seconds. The screen will indicate the setting.

LCD Screen Brightness (75% by Default): Your safe has four different brightness settings: 25%, 50%, 75%, and 100%. To toggle the brightness press and hold keys '3' and '6' together. The LCD screen will indicate the setting.

Interior Light and Duration (10s by Default): Your safe has an interior light which can be toggled ON/OFF and has different interior light durations: 10 seconds, 30s, and 60s. To toggle the duration press and hold keys '3' and '5' together. The light will always stay ON when the safe is plugged into a power source.

Impact Detection (DMT) (Medium by Default): Your safe has a built-in accelerometer and corresponding alarm that alerts of any attacking to your safe including bumps and impacts, DMT (Impact Detection). There are four different DMT sensitivity settings; Low, Medium, High, and Disabled. You can toggle through these settings by pressing and holding the '7' key and Program button together for 3 seconds. The screen will indicate the sensitivity.

Alert of Unauthorized Access (ON by Default): If enabled, and someone forcefully enters the safe or opens the safe by picking the lock, the keypad will start flashing and beeping. You can clear the alert by entering master code. To toggle this feature press and hold the '6' key and Program button together for 3 seconds. The LCD screen will indicate ENABLED or DISABLED.

Open Door Alarm (ON by Default): Your safe features an open door alarm that will sound when the safe door is left open for more than 8 minutes. To toggle this feature press and hold the '5' key and Program button together for 3 seconds. The LCD screen will indicate OFF or ON.

Factory Reset: Open the safe using the included key and leave the key turned all the way in the clockwise position. Press and hold keys '2' '7' and the Program button together until the safe restarts. The factory reset will erase all programmed information and restores the safe to its factory default settings. The master code is rest...

KEYPAD HOTKEYS Continued

to 1-2-3-4, and the safe will restart.

PRODUCT REGISTRATION

Vaultek strongly encourages you to register your safe as soon as you receive it. **Registration provides many benefits including three year warranty, technical support and ordering replacement keys should you misplace them.** Please visit the Vaultek website at vaulteksafe.com and click Support/Product Registration and enter the required information.

SUPPORT

If you have any questions about your safe or need help configuring the system, we encourage you to visit vaulteksafe.com/support/ and select your model for troubleshooting, FAQs, and helpful videos. You can also email us at support@vaulteksafe.com.

Visit our mobile-friendly online guide. Includes tutorial videos at vaulteksafe.com/support and select your model.

DISCLAIMER

NEITHER SELLER NOR MANUFACTURER SHALL BE LIABLE FOR UNAUTHORIZED ACCESS, ANY INJURY, LOSS OR DAMAGE TO PERSONAL PROPERTY DIRECT OR CONSEQUENTIAL, ARISING OUT OF THE USE OF, OR THE INABILITY TO USE THE VAULTEK® SAFE.

THE USER SHALL DETERMINE THE SUITABILITY OF THE VAULTEK® SAFE BEFORE THE INTENDED USE AND USER ASSUMES ALL RISK AND LIABILITY WHATSOEVER IN CONNECTION THEREWITH. VAULTEK® SAFES ARE NOT INTENDED TO PROTECT AGAINST ENVIRONMENTAL HAZARDS INCLUDING FIRE AND WATER.

FCC

REV 010925

This device complies with part 15 of the FCC rules. Operation is subject to the following two conditions:

- (1) this device may not cause harmful interference, and
- (2) this device must accept any interference received, including interference that may cause undesired operation.

NOTE: The manufacturer is not responsible for any radio or TV interference caused by unauthorized modifications or changes to this equipment. Such modifications or changes could void the user's authority to operate the equipment.